

COR 70 HIDDEN SASH

SYSTEM

Sightlines

Frame 70 mm, Sash 70 mm

Polyamide Strip Length

35 mm

Profile Thickness

Window 1.9 mm

Glazing

Max. 40 mm, Min. 26 mm

Maximum Sash Dimensions

Standard Solution:

Width (L) 1300 mm, Height (H) 2400 mm

HD Hardware (Side Hung):

Width (L) 1200 mm, Height (H) 3500 mm

Maximum Sash Weight

160 Kg

Consult maximum weight and dimensions according to typologies



COR 70 HIDDEN SASH SYSTEM



It could be a painting, but is a window. This is how we can describe the COR 70 Hidden Sash which, like the 80 mm version, has a sightline of only 66 mm and allows the incorporation of the ARCH INVISIBLE handle, concealed hinges and the drainage solution. Any element that breaks the visual harmony of the ensemble is discarded.



- High thermal & acoustic performance
- Slim sightlines
- Hidden handle and concealed hinges available
- High security

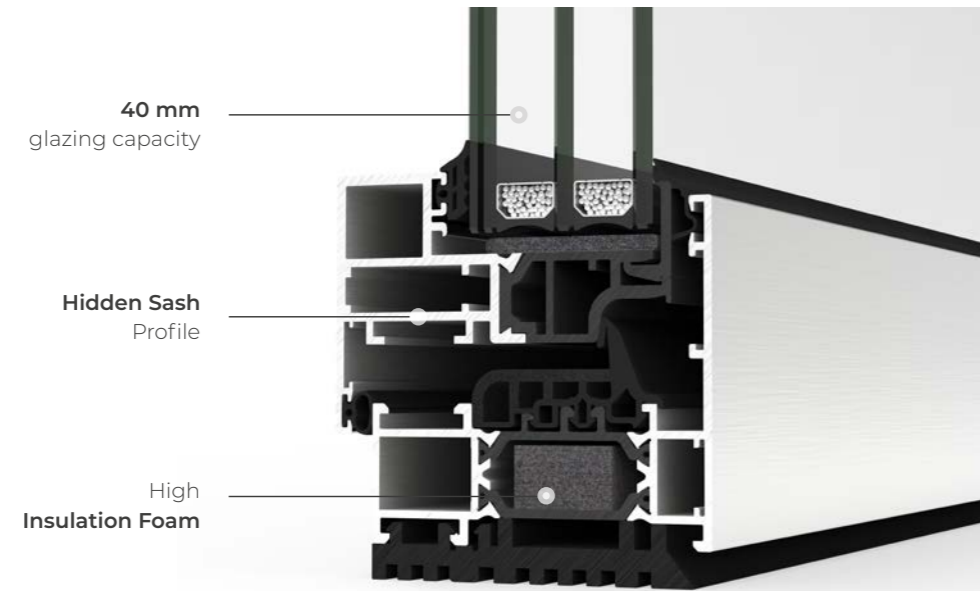

BFRC Rating
kWh/(m²·yr)

≥20	A ++
>10 to <20	A +
0 to <10	A ✓
-10 to <0	B
-20 to <-10	C
-30 to <-20	D
-50 to <-30	E

Double glazing

BFRC Rating
kWh/(m²·yr)

≥20	A ++
>10 to <20	A + ✓
0 to <10	A
-10 to <0	B
-20 to <-10	C
-30 to <-20	D
-50 to <-30	E

Triple glazing



FEATURES		
U value		Double glazing Uw from 1.2 (W/m ² K) Triple glazing Uw ≥ 0.8 (W/m ² K)
Acoustic insulation		Rw up to 46 dB
Air permeability		Class 4
Water tightness		Class E1650
Wind resistance		Class C5
Security test	PAS24 ✓	Passed

Double glazing Ug=1.0 / Triple glazing Ug=0.5
Reference test 1.23 x 1.48 m / 1 sash
Security test: Reference test 1.100 x 2.400 m / 1 sash
CSTB Laboratory DTA Certification



ARCH INVISIBLE HANDLE

CROSS SECTION

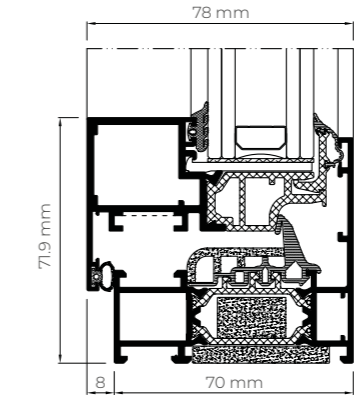

FLOATING MULLION

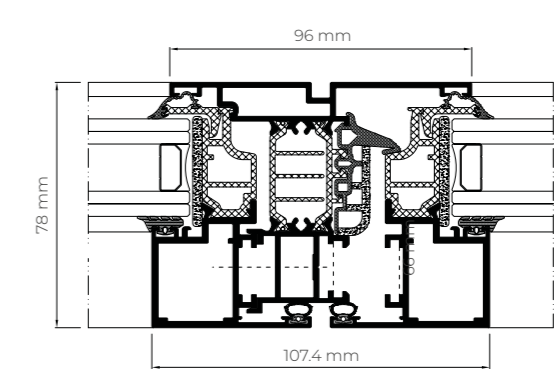

HIDDEN DRAINAGE

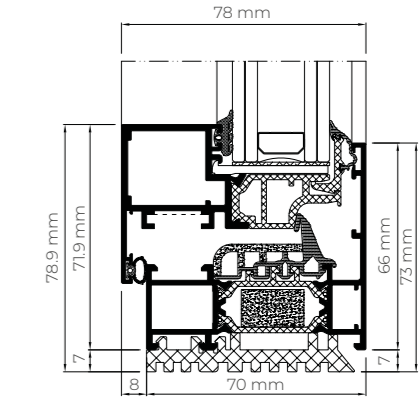

DRAINAGE SUBCILLS

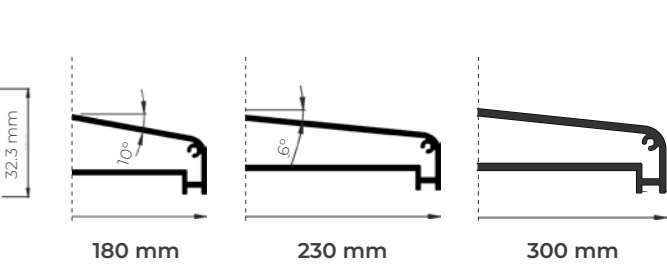
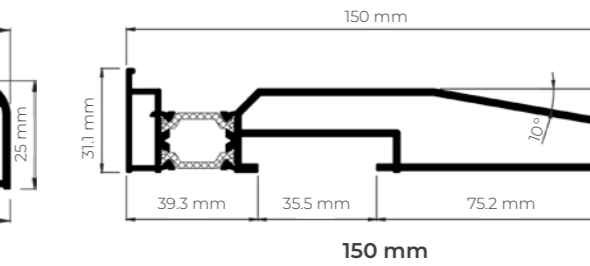
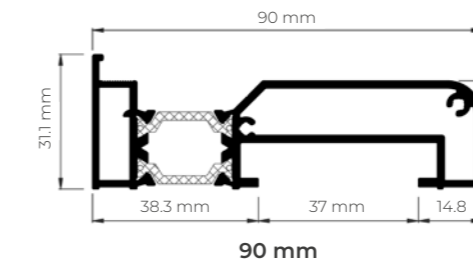

HEAD EXTENSION

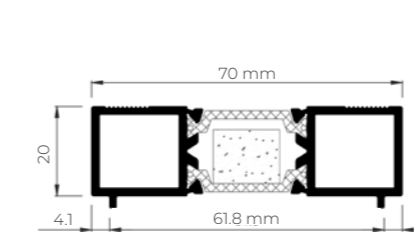

Head Extension 20 mm

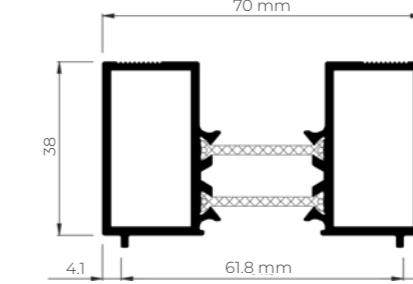

Head Extension 38 mm

POSSIBILITIES

- SECURITY HARDWARE
- CONCEALED HINGES
- CONCEALED HANDLE
- CONCEALED DRAINAGE

OPENING POSSIBILITIES

- Inward Opening
- Side hung
- Tilt & turn
- Tilt only